

Airport High School Band
1315 Boston Avenue, West Columbia, SC 29170
822-5628

Dear Color Guard Directors,

Thank you for choosing Airport High School as one of your contest sites for 2007. I think you will find our facilities more than accommodating. I wish to invite all of you to come to our hospitality room and enjoy some food, beverage, and friendship.

Enclosed you will find information concerning the contest, maps of the facilities, and maps and directions to our school. The schedule is available online at the www.cwea.us website. We will have a concession stand available for you, your performing members, and spectators.

If you need any more information or have any questions please feel free to contact us by e-mail at rknight@lex2.org or call us 803-822-5628. Thank you again for joining us on March 17, 2007. I hope you have a great performance and a successful season.

Sincerely,

Rick Knight
Band Director

Location of Competition:
AIRPORT HIGH SCHOOL
1315 Boston Avenue
West Columbia, SC 29170

Date and Time: March 17, 2007
Beginning at 12:55 PM

Tickets: \$5.00

If you are bringing a tractor-trailer for your equipment, please contact Rick Knight at (803)331-9983 or rknight@lex2.org as soon as possible.

Performer Check-in: Marching members and ten (10) staff, chaperones, etc. will be admitted and must check in together. All performing members and staff must be hand stamped and/or wrist-banded when checking in. Additional staff members must purchase tickets. You will be able to purchase tickets at check in for any additional staff or chaperones. Units must check in one (1) hour prior to their performance time. Check in will open at 11:00 AM.

Dressing Facilities: Dressing rooms will be open for the performers to change. Please vacate in a timely fashion to allow space for other guards. Neither Airport High School nor the Carolina Winter Ensemble Association will not be responsible for any lost, stolen, or damaged property.

Footwear and Equipment: All equipment tips of rifles, poles, and sabers must be padded. Any props used must be protected to avoid damaging the floor. Soft-soled shoes need no protection. Hard-soled shoes must be taped. All carts and rolling equipment must have clean, working wheels.

Inspections: Equipment and props will be inspected in the holding area prior to the performance.

Floor Size: Contest floor will be at least 50' x 70' with sufficient room at the end and backside. We will have a floor mat covering the entire gym floor that will be down as protection. If you are bringing a floor, your floor will go over the floor mat.

Equipment Removal: All equipment MUST be removed from the gym immediately following your performance.

Tabulating and Judging Area: Only authorized personnel will be allowed in the tabulating and judging area. You may pick up your music at the announcer's table shortly after your unit completes your show. DO NOT APPROACH THE TABULATION TABLE! You can pick up your judges tapes and show music at the announcer's table approximately 30 minutes after your performance.

Show Music: Music should be turned in to the sound technician at least 30 minutes prior to the unit's performance. A cassette tape deck and CD player will be provided for your use. You may use your own deck and plug into the sound system provided. Please bring all necessary cords.

Sound Checks: This will take place from 11:45 AM-12:50 PM. After this scheduled time, sound checks will only take place during official show breaks.

Warm-ups: There will be ample space provided for your unit's preparation for the show. There will be a body warm-up area and an equipment warm-up area. The body warm-up area is a small gym. The equipment warm-up is a full size gym just outside the main gym. We request that you adhere to the rotation schedule to keep the show on schedule. These facilities will be inside. If you choose, there is ample outside space for warm up. You still need to report to the holding area at your designated report time.

Retreat: There will be two retreats. The first will begin at approximately 3:25 PM for the Cadet, Scholastic Regional A, and Scholastic AAAA units. The second retreat will be at approximately 8:00 PM for Scholastic AAA, AA, and A as well as Independent A and Independent Open units. Retreat will be a ***captain's retreat***. All captains should report to the equipment warm-up area immediately following the last unit's performance.

Video taping: A video tape of your performance will be provided from up top by Airport High School. Videographers from individual units will not be allowed in the same area as our videographer.

Photography: No flash photography will be allowed. This is very dangerous to the performers.

Guard Grams: We will have Eagle Grams available at a cost of \$2.00 each. The Announcer will use discretion when reading Eagle Grams. Inappropriate messages will not be read and no refund will be provided.

Souvenir Tables: A few tables will be available at a cost of \$100. To reserve a space, please contact Rick Knight at rknight@lex2.org or 803-822-5628.

Concession Stand: Our concession stand will be open from 11:00 AM until approximately 9:00 PM. Among the items we will be serving are hamburgers, hot dogs, pizza, chicken fingers, nachos, candy, bottled water, coffee, and soft drinks.

Hospitality Room: There will be a Hospitality Room available for Directors which will include food and drink. Please stop by and enjoy.

Critique: There will be a sign up sheet available at the Announcer's Table. Critique will take place on a first come first serve basis. The critique will take place in the judge's lounge.

Emergency Numbers: Airport H.S. 803-822-5628
Day of Show for directors only 803-331-9983.

Please Note: Airport H.S. is a Smoke Free Campus and we will enforce a **NO SMOKING** policy. Thank you for your cooperation.

Directions to Airport High School

From Anderson/Greenville – Take I-85 north to I-385. Take I-385 toward Columbia to I-26. Take I-26 toward Columbia to Exit 113 – Hwy. 302. This is the exit for Airport High School. At the light at the end of the exit ramp, turn right. Go to the second light and turn right at the Lizard’s Thicket restaurant onto Boston Avenue. Airport High School is approx. ½ mile down Boston Ave. on the left.

From Spartanburg - Take I-26 toward Columbia to Exit 113 – Hwy. 302. This is the exit for Airport High School. At the light at the end of the exit ramp, turn right. Go to the second light and turn right at the Lizard’s Thicket restaurant onto Boston Avenue. Airport High School is approx. ½ mile down Boston Ave. on the left.

From Aiken – Take I-20 toward Columbia. Take the US 1 exit. Take US 1 toward West Columbia. Then take I-26 toward Charleston. Get off on the next exit, Exit 113. Turn right onto Hwy. 302. Go to the second light and turn right at the Lizard’s Thicket restaurant onto Boston Avenue. Airport High School is approx. ½ mile down Boston Ave. on the left.

From Charleston/Orangeburg – Take I-26 toward Columbia. Take Exit 113 – Hwy. 302. At the light at the end of the ramp, turn left. Go to the third light and turn right at the Lizard’s Thicket restaurant onto Boston Avenue. Airport High School is approx. ½ mile down Boston Ave. on the left.

From Greenwood – Take Hwy. 72 to I-26. Take I-26 toward Columbia. Take Exit 113 – Hwy. 302. This is the exit for Airport High School. At the light at the end of the exit ramp, turn right. Go to the second light and turn right at the Lizard’s Thicket restaurant onto Boston Avenue. Airport High School is approx. ½ mile down Boston Ave. on the left.

From Lexington – Take U.S. 1 to I-26. Take I-26 toward Aiken/Augusta. Take Exit 113 – Hwy. 302. This is the exit for Airport High School. At the light at the end of the exit ramp, turn right. Go to the second light and turn right at the Lizard’s Thicket restaurant onto Boston Avenue. Airport High School is approx. ½ mile down Boston Ave. on the left.

From Saluda – Take Hwy. 378 to U.S.1 in Lexington. Take U.S. 1 to I-26. Take I-26 toward Aiken/Augusta. Take Exit 113 – Hwy. 302. This is the exit for Airport High School. At the light at the end of the exit ramp, turn right. Go to the second light and turn right at the Lizard’s Thicket restaurant onto Boston Avenue. Airport High School is approx. ½ mile down Boston Ave. on the left.

Directions to Airport High School

From Anderson/Greenville – Take I-85 north to I-385. Take I-385 toward Columbia to I-26. Take I-26 toward Columbia to Exit 113 – Hwy. 302. This is the exit for Airport High School. At the light at the end of the exit ramp, turn right. Go to the second light and turn right at the Lizard’s Thicket restaurant onto Boston Avenue. Airport High School is approx. ½ mile down Boston Ave. on the left.

From Spartanburg - Take I-26 toward Columbia to Exit 113 – Hwy. 302. This is the exit for Airport High School. At the light at the end of the exit ramp, turn right. Go to the second light and turn right at the Lizard’s Thicket restaurant onto Boston Avenue. Airport High School is approx. ½ mile down Boston Ave. on the left.

From Aiken – Take I-20 toward Columbia. Take the US 1 exit. Take US 1 toward West Columbia. Then take I-26 toward Charleston. Get off on the next exit, Exit 113. Turn right onto Hwy. 302. Go to the second light and turn right at the Lizard’s Thicket restaurant onto Boston Avenue. Airport High School is approx. ½ mile down Boston Ave. on the left.

From Charleston/Orangeburg – Take I-26 toward Columbia. Take Exit 113 – Hwy. 302. At the light at the end of the ramp, turn left. Go to the third light and turn right at the Lizard’s Thicket restaurant onto Boston Avenue. Airport High School is approx. ½ mile down Boston Ave. on the left.

From Greenwood – Take Hwy. 72 to I-26. Take I-26 toward Columbia. Take Exit 113 – Hwy. 302. This is the exit for Airport High School. At the light at the end of the exit ramp, turn right. Go to the second light and turn right at the Lizard’s Thicket restaurant onto Boston Avenue. Airport High School is approx. ½ mile down Boston Ave. on the left.

From Lexington – Take U.S. 1 to I-26. Take I-26 toward Aiken/Augusta. Take Exit 113 – Hwy. 302. This is the exit for Airport High School. At the light at the end of the exit ramp, turn right. Go to the second light and turn right at the Lizard’s Thicket restaurant onto Boston Avenue. Airport High School is approx. ½ mile down Boston Ave. on the left.

From Saluda – Take Hwy. 378 to U.S.1 in Lexington. Take U.S. 1 to I-26. Take I-26 toward Aiken/Augusta. Take Exit 113 – Hwy. 302. This is the exit for Airport High School. At the light at the end of the exit ramp, turn right. Go to the second light and turn right at the Lizard’s Thicket restaurant onto Boston Avenue. Airport High School is approx. ½ mile down Boston Ave. on the left.

Airport Winter Guard Contest
Parking Procedures

Due to construction and a Spring Sports Festival at Airport High School on the same date as the Winter Guard Contest, please use the following procedures:

Unit Drop-off/Parking

Buses will drop-off students, staff, chaperones, etc. at the registration area in front of the auditorium. Buses will then proceed next door to Fulmer Middle School where they will park. Students may report to their bus at Fulmer after the contest or buses will be allowed to pick up students at the drop-off area.

Equipment Drop-off/Parking

Equipment trailers will drive to the back of the campus and unload their equipment. It will be stored in the Vocational Hallway adjacent to the gym. Equipment vehicles will then proceed to Fulmer Middle School where they will park. You may come back to pick up your equipment anytime after your unit's performance. **We strongly encourage you to pick up your equipment/props, etc. shortly after your unit has performed so that we don't have a "log jam" at the end of the contest.**

If you plan to bring a tractor-trailer for your equipment, please contact Rick Knight at (803)331-9983 or rknight@lex2.org as soon as possible.

Spectator Parking

There will be a limited amount of spectator parking on campus at Airport High School. All other spectators will park at Fulmer Middle School or at the Disability Determination Services Building located one block before you get to Airport High School. **All spectator parking areas will be clearly marked.**

The AHS athletic department will be charging to park in the lots labeled "Sports Festival Parking" on the map.

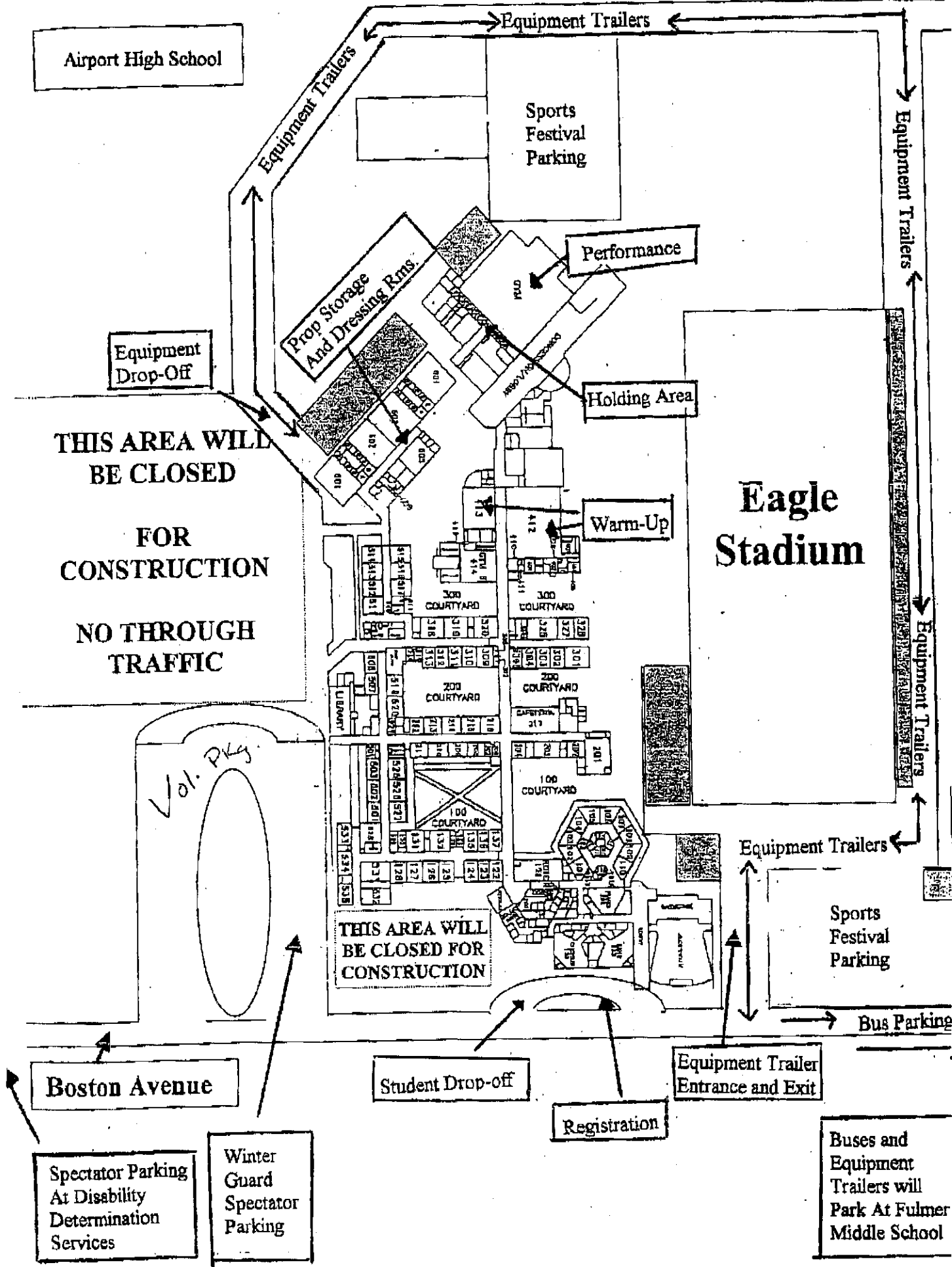

Airport High School

Equipment Trailers

Equipment Trailers

Sports Festival Parking

Performance

Equipment Drop-Off

Prop Storage And Dressing Rms.

Holding Area

THIS AREA WILL BE CLOSED FOR CONSTRUCTION NO THROUGH TRAFFIC

Warm-Up

Eagle Stadium

Equipment Trailers

Equipment Trailers

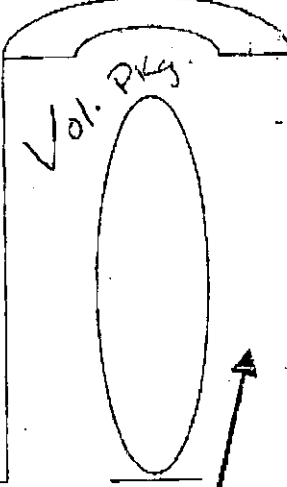

THIS AREA WILL BE CLOSED FOR CONSTRUCTION

Equipment Trailers

Sports Festival Parking

Bus Parking

Boston Avenue

Student Drop-off

Equipment Trailer Entrance and Exit

Registration

Spectator Parking At Disability Determination Services

Winter Guard Spectator Parking

Buses and Equipment Trailers will Park At Fulmer Middle School

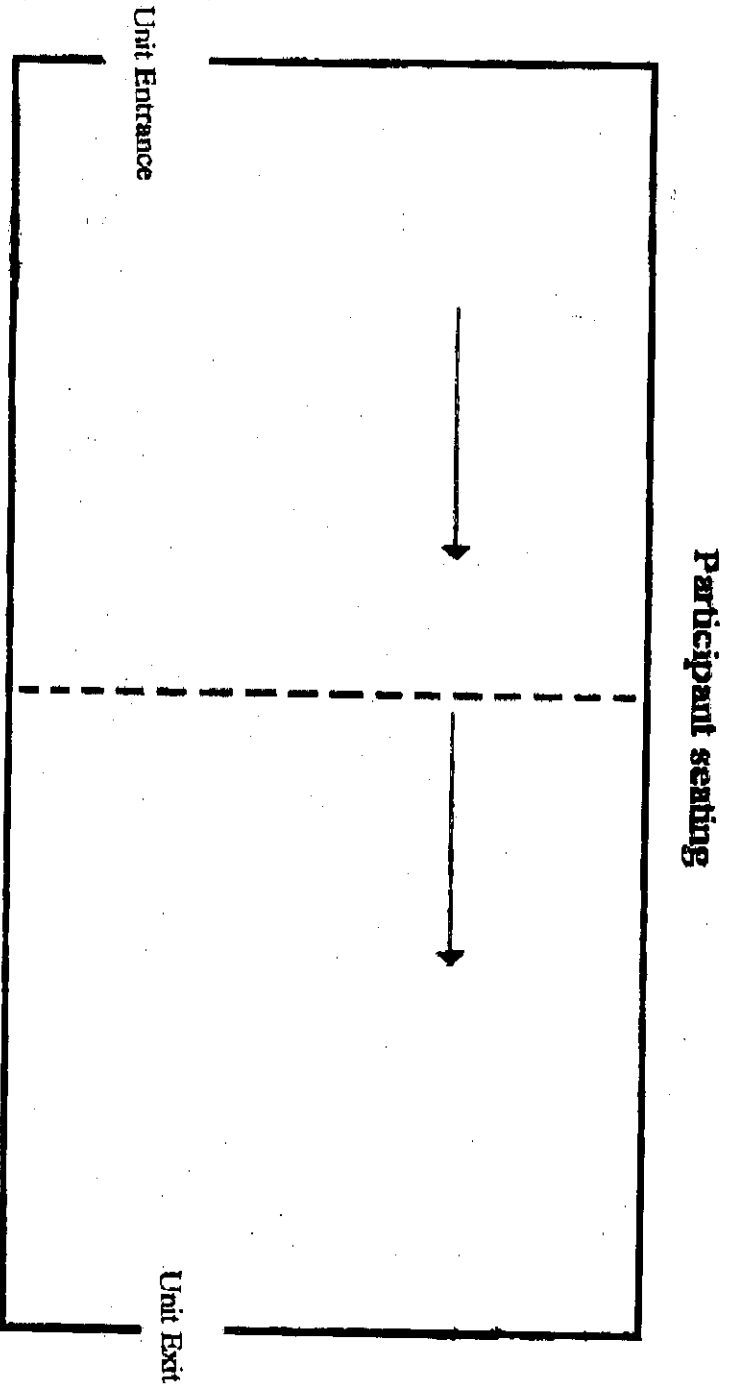

Fold your floors for a VERTICAL timing line as illustrated above.

Fulmer Middle School

Spectator Parking

Bus Parking

Spectator Parking

Equipment Vehicles (park on left side of street only)

Bus Parking (park on right side of street only)

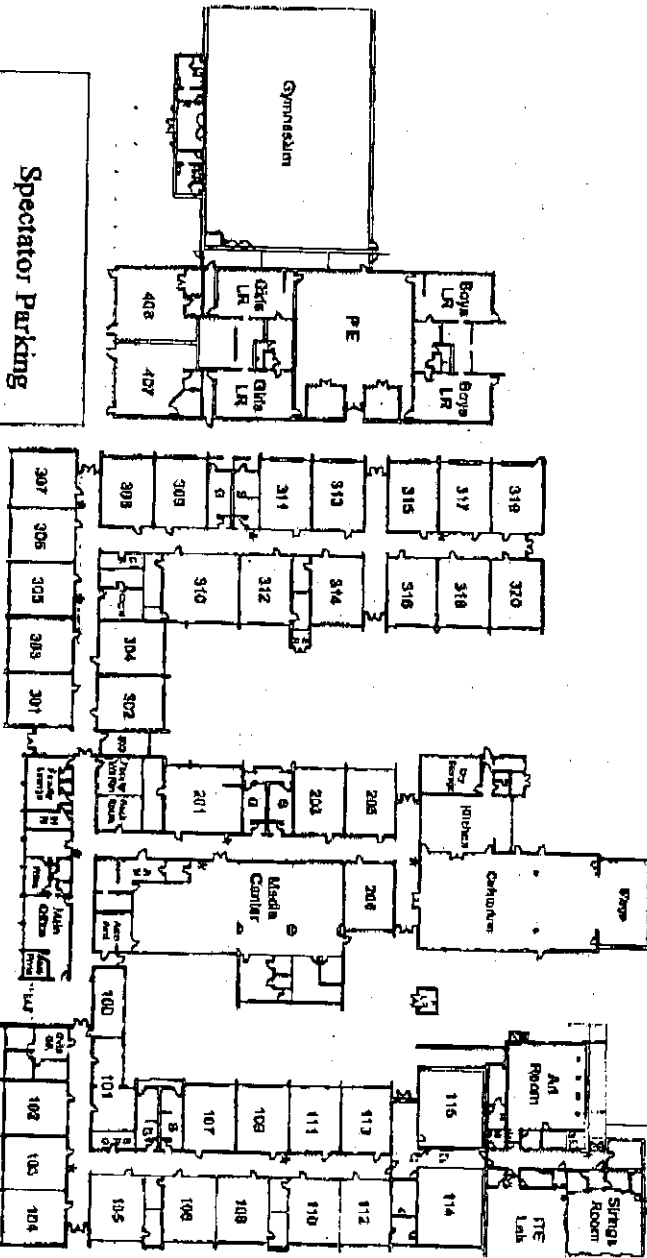

Equipment Vehicles

Airport High School